

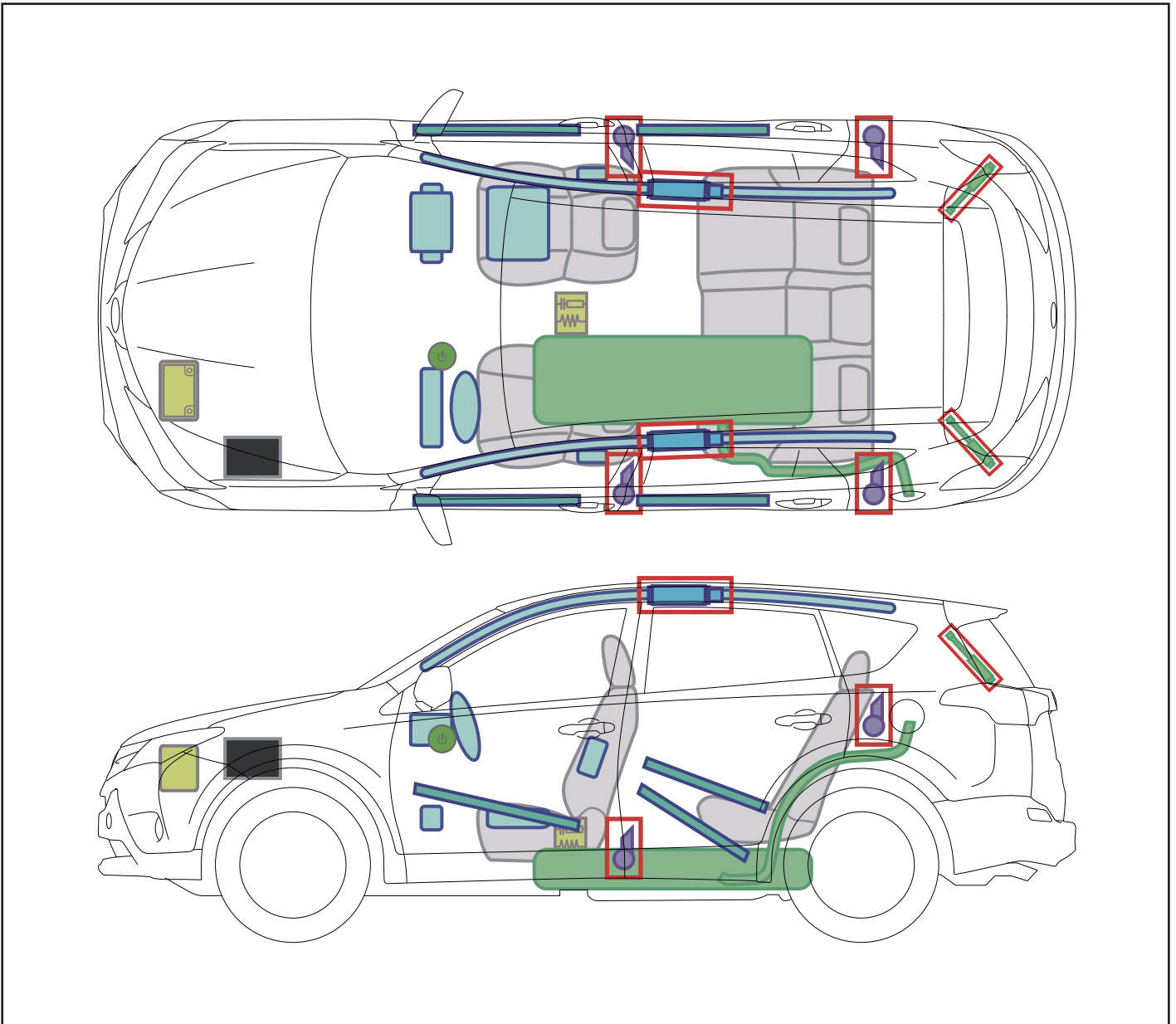









# RAV4

XA 3 (a)

ab 09.2013



	<b>Zündschalter</b>		<b>Sicherungskasten</b>		<b>12V Batterie</b>
	<b>Airbag</b>		<b>Gasgenerator</b>		<b>Kraftstofftank</b>
	<b>Gasdruckdämpfer</b>		<b>Gurtstraffer</b>		<b>Karosserieverstärkung</b>
	<b>Steuergerät</b>				

### Fahrzeug ausser Betrieb setzen

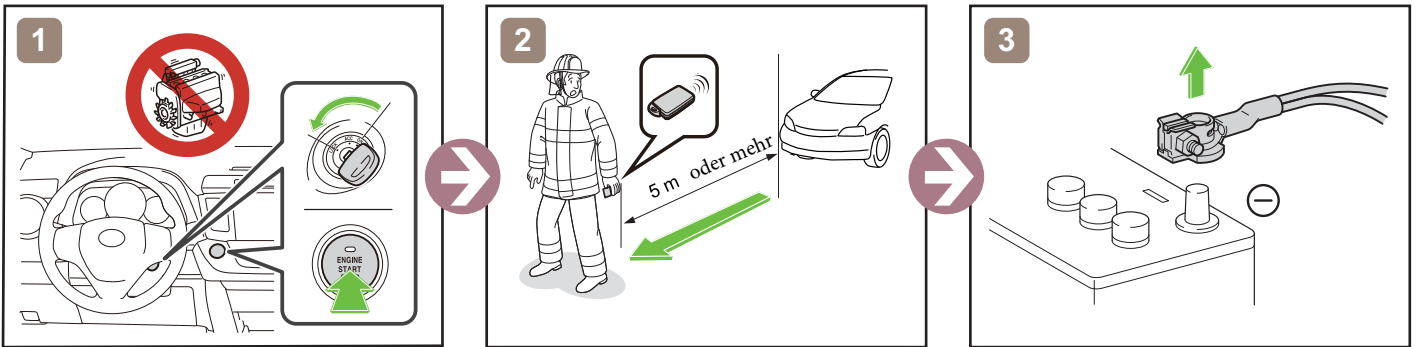

oder

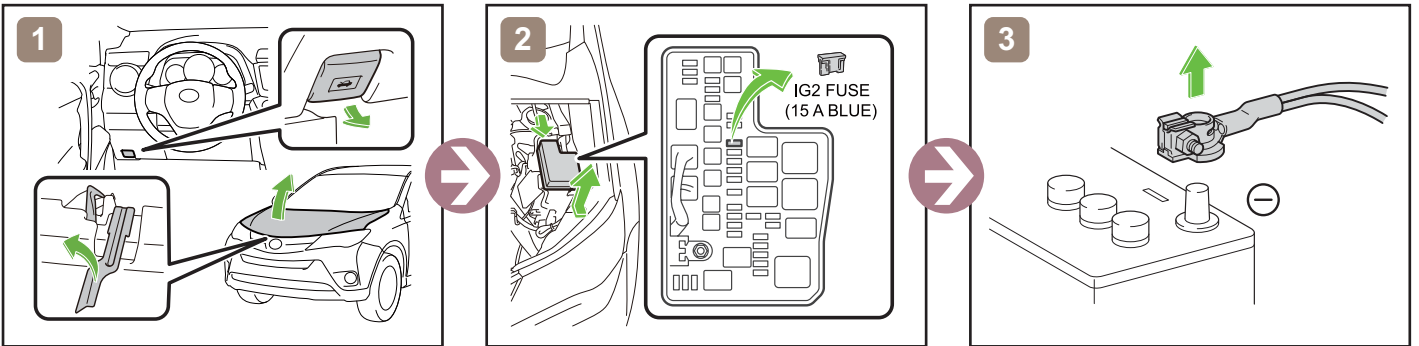

### Zugang 12V Batterie

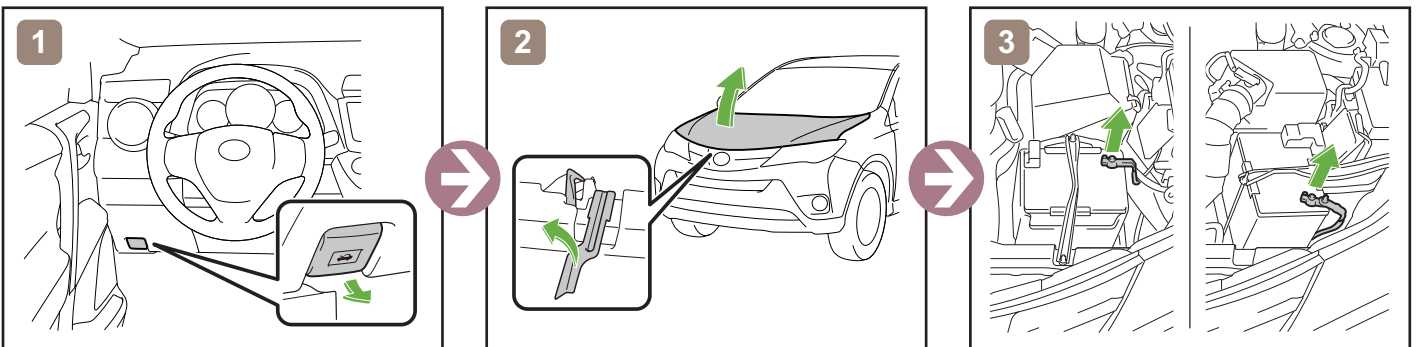

### Hinweise zum Transport

